

LEGENDA	
	PAV - EXECUTAR
	SENTIDO - PISTA

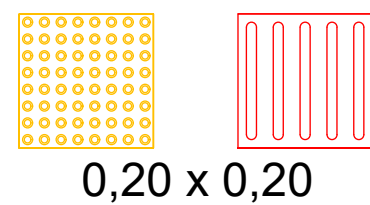

Planta de pavimentação
1:500

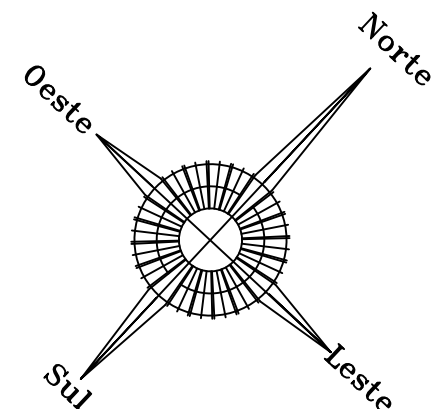
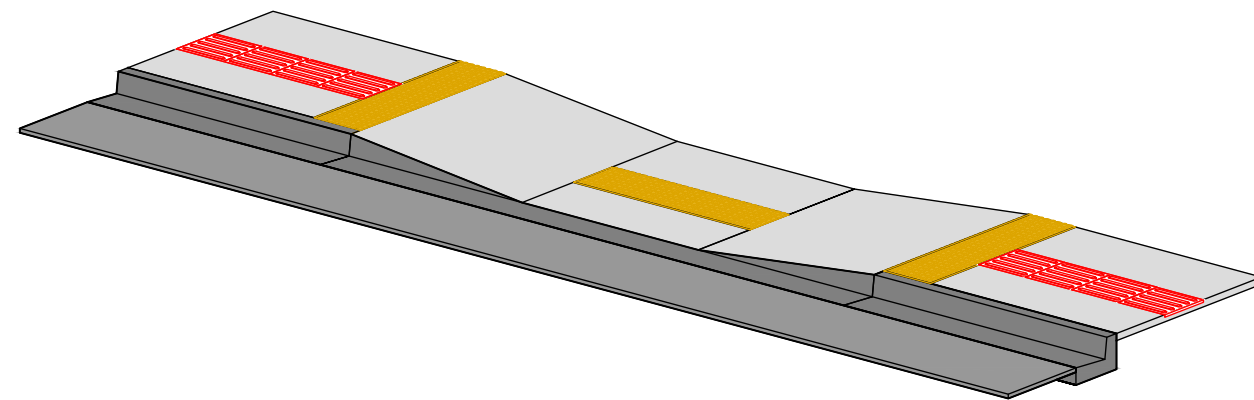
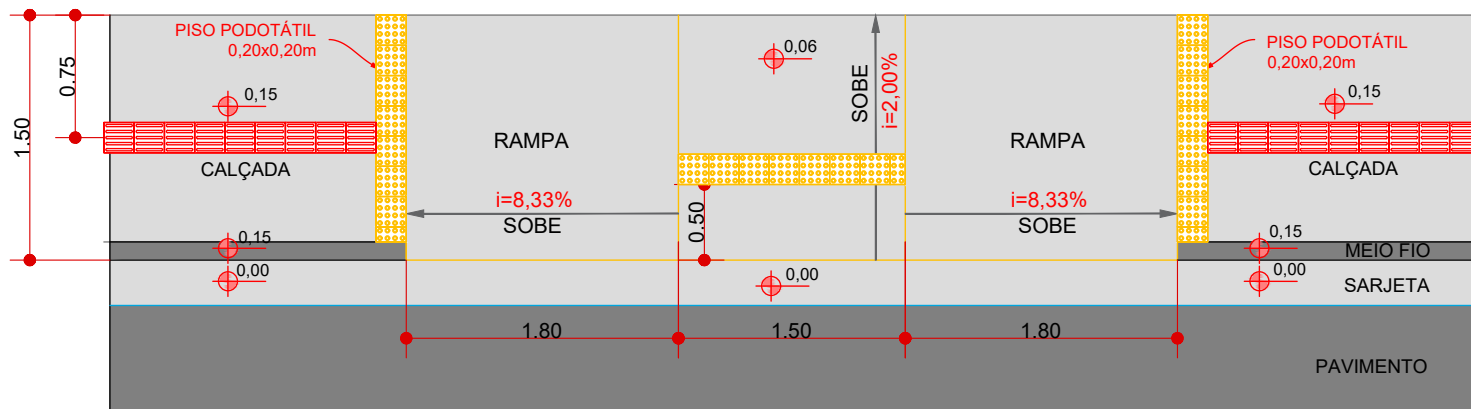

DETALHE DO ACESSO
AO PASSEIO E CALÇADAS
ESCALA:1/300

IMPLANTAÇÃO DA CALÇADA

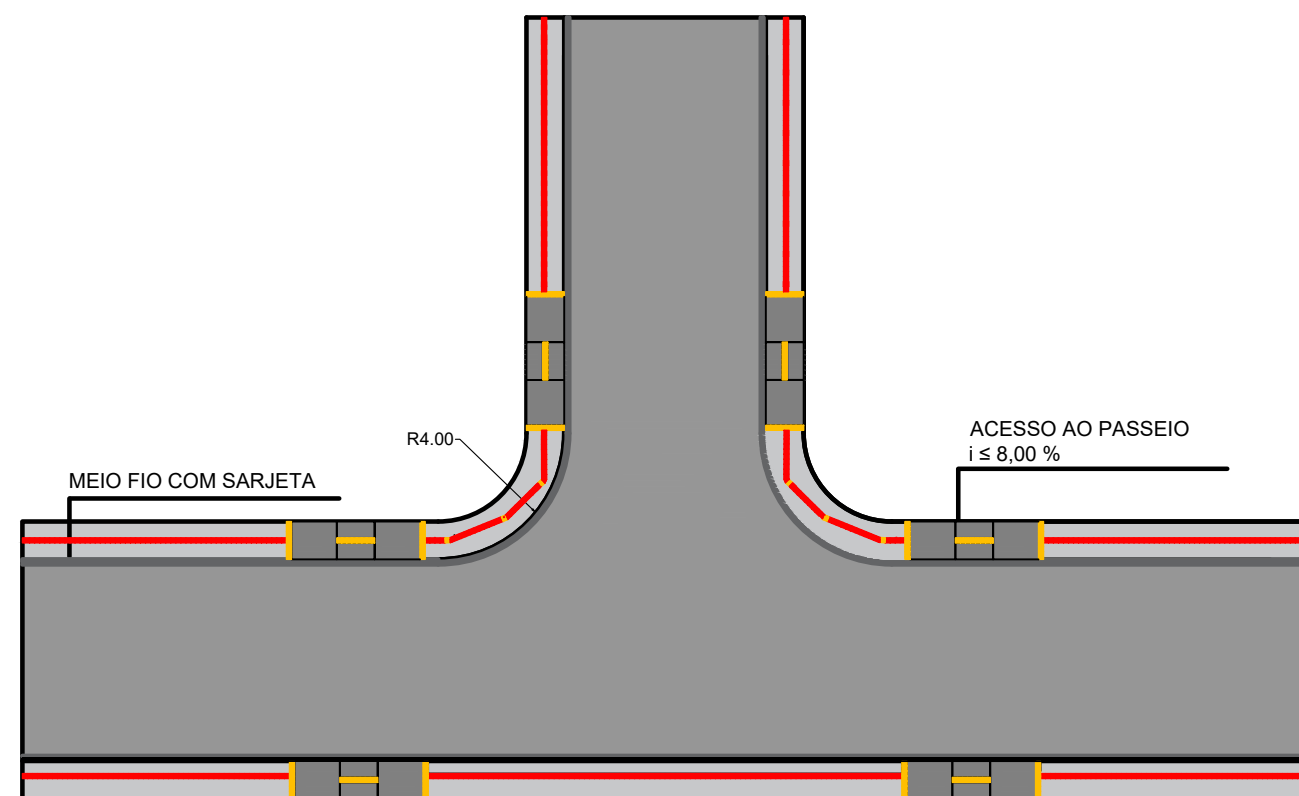
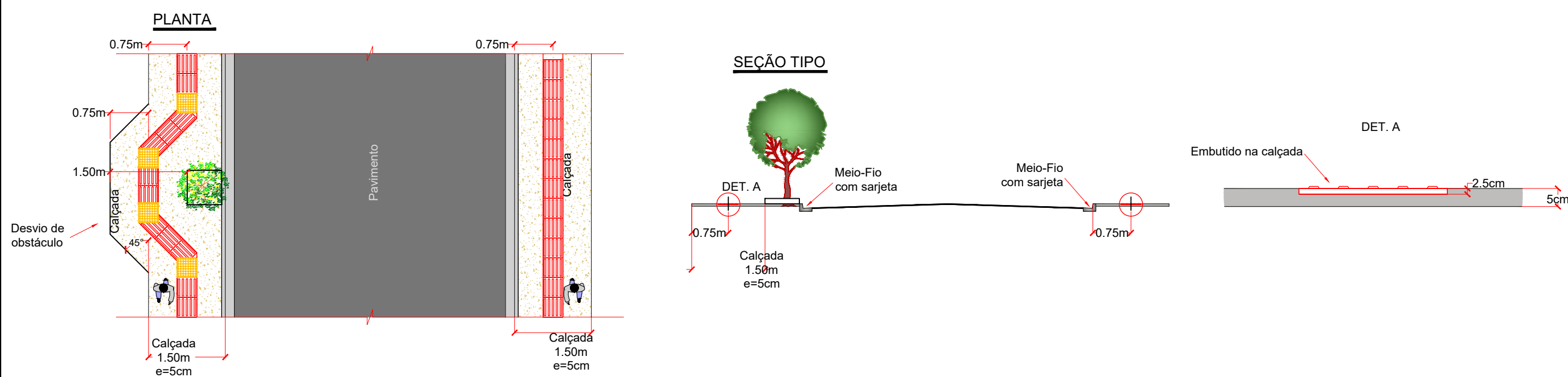

COMPRIMENTO DOS TRECHOS (m) - PISO PODOTÁTIL DIRECIONAL E PISO ALERTA

①	17,15
②	15,52
③	19,94
④	24,26
⑤	04,10
⑥	14,38
⑦	161,20
⑧	24,68
⑨	26,63
⑩	153,15
⑪	42,42
⑫	125,69
⑬	16,86
⑭	111,15
⑮	08,61

APROVAÇÃO

R0	09/2025	EMISSION INICIAL			
REVISION	DATA	DESCRIPTION			
PROJECT TITLE					
LOTTEMENT POPULAR - FNHS SUB-50					
- Proposal n°040064/2025					
OWNER					
MUNICIPALITY OF SIDROLÂNDIA					
SECRETARIAT OF GOVERNMENT AND DEBUREOCRATIZATION					
CNPJ					
03.501.574/0001-31					
ADDRESS					
RUA SHOYCHI ARAKAKI					
EXISTING CORRIDOR - ACCESS TO THE REFRIGERATOR					
CEP 79.170-000 - Sidrolândia-MS					
COORDINATES: 20°56'46.23"S / 54°57'7.34"O					
PRANCHA TITLE					
PLANT OF PAVEMENTS AND ACCESSIBILITY					
DESCRIPTION OF THE STAGE					
URBAN ACCESSIBILITY PROJECT					
NAME: PRANCHA - ARCHIVE		REVISION	UNIT	DATE	SCALE
ACCESSIBILITY_AGEHAB_FL1.1		R0	METERS	SET/2025	INDICATED
AUTHOR(S) OF THE PROJECT EXECUTIVE		MAYOR MUNICIPAL			
MARCEL THEODORO BARCELLOS		RODRIGO BORGES BASSO			
CREA /MS 70442		03.501.574/0001-31.			



ACESSIBILIDADE
PRANCHA
ÚNICA